



Date: 9/28/2020

## REQUEST FOR QUOTATION

Project Number: \_\_\_\_\_  
Reference PR Number: 2020-09-2183

Sir/Madam:

Please quote your best offer for the item/s listed below, subject to the Terms and Conditions provided. Submit your quotation duly signed by you or your duly authorized representative at the Procurement Management Division or e-mail at [rs.luna@philrice.gov.ph](mailto:rs.luna@philrice.gov.ph) not later than **10/6/2020: 5:00 PM.**

*RS*  
**RAYCHELL S. LUNA**  
BUYER/CANNASSER

**PROCUREMENT TERMS AND CONDITIONS**

*Ray A. Raveilo*  
**GLENDA D. RAVEILO**  
Division Head

- The Approved Budget for the Contract (ABC) is **Php 996,732.19.**
- Prices quoted are subject to deduction of 5% VAT & 1% EWT (for goods) or 5% VAT & 2% EWT (for services).
- All bids in excess of the ABC will be rejected.
- Complete technical specifications, brand and model must be indicated in the price quotation for evaluation purposes.
- Delivery period shall be indicated in the quotation. Liquidated damages equivalent to 1/10 of 1% per day of delay for the value of undelivered items shall be imposed.
- Goods, supplies, equipment, or work done are subject to inspection/acceptance, PhilRice reserves the right to cancel, reject, or rebid the items which do not conform with the technical specifications.
- NEW** suppliers are required to submit a photocopy of **valid Mayor's Business Permit, valid PhilGEPS Registration Number and valid PCAB License (if applicable)** together with their quotations. Please disregard if you have submitted an updated copy/ies. This shall be subjected for validation.
- The winning Bidder is required to submit a photocopy of **Latest Income/Business Tax Return and original copy of Omnibus Sworn Statement** prescribed by the GPPB **PRIOR TO PAYMENT** of the goods delivered/services rendered.
- Supplier warrants that s/he has not given nor promised to give any money or gift to any PhilRice employee to secure this offer and to obtain an award.

Item No.	Quantity	Unit	Item and Description	Unit Price	Total Amount
1	1	lot	Improvement of Air-strip at PhilRice Central Experiment Station (PR#2020-09-2183)		
Note: Site inspection is required to ensure the soundness of your computed bid.					

**Reminders:**

- The following must be submitted (together with the Eligibility Documents stated in #7 of the Procurement Terms and Condition of the RFQ), in a short brown envelope (sealed & signed) at the Procurement Management Division or e-mailed at [rs.luna@philrice.gov.ph](mailto:rs.luna@philrice.gov.ph):
  - Request for Quotation
  - Bill of Quantities
  - Detailed Estimates (preferably computerized)
  - All documents must be accomplished completely and signed by the authorized bidder in each and every page. Erasures should be countersigned.
  - Failure to comply with the above-mentioned requirements shall be a ground for **DISQUALIFICATION.**

\* Please refer to the attached list of minimum requirements for key personnel and equipment.

- Delivery Period:     30 calendar days     15 calendar days     7 calendar days     Others: \_\_\_\_\_    Contract Duration: 120 CD
- Place of Delivery:     PhilRice CES-Central Warehouse     ATI-QC     Others: \_\_\_\_\_
- Price Validity:     120 calendar days     60 calendar days     30 calendar days     Others: \_\_\_\_\_
- Warranty:     1 year     3 months     Others: \_\_\_\_\_
- Payment Term:     30 calendar days     15 calendar days     Others: \_\_\_\_\_

After having carefully read and accepted the Procurement Terms & Conditions, I/We quote you on the item at prices noted above.

PRINTED NAME/SIGNATURE OF AUTHORIZED REPRESENTATIVE

Designation: \_\_\_\_\_  
Company Name: \_\_\_\_\_  
Business Address: \_\_\_\_\_  
PhilGEPS Registration No.: \_\_\_\_\_  
Telephone Number: \_\_\_\_\_  
Email Address: \_\_\_\_\_

PRRI RFQ Rev. 5 Effectivity Date: Oct 29, 2019



PROJECT : IMPROVEMENT OF AIR STRIP AT PHILRICE CES  
 SUBJECT : BILL OF QUANTITIES  
 LOCATION : PHILRICE-CES, SCIENCE CITY OF MUÑOZ, NUEVA ECIJA

QUANTITY	UNIT	PARTICULARS	UNIT COST	MATERIALS COST	LABOR + EQUIP COST	TOTAL AMOUNT	OCM	PROFIT	TAX 5%	AMOUNT
<b>I. SITEWORKS</b>										
141.00	cu.m	Excavation								
42.30	cu.m	Backfill								
<b>II. CONCRETE WORKS</b>										
For Airstrip Concrete Works and Helipad										
141.00	cu.m	Ready Mix, 3500psi @ 28 days, Curing Compound								
<b>III. MASONRY WORKS</b>										
For Concrete Wall Signage (@Entry of Field) And Hollow Art (@Front of PPD)										
13.40	sq.m.	Portland Cement, Washed Sand, 3/4 Crushed Gravel, 12mm diam DRSB, Small Boulders (Riprap), 1.20 x 2.40m Ga. 10 Steel Matting, Ga. 16 Tie Wire, Consumables								
<b>IV. FORMWORKS AND SCAFFOLDINGS</b>										
1.00	L.S.	C Purlins (2"x6"x1.5mm)								

**SUMMARY OF COST**

Direct Cost

Material Cost + Labor Cost + Equipment Rental Cost

PhP \_\_\_\_\_

OCM ( )%

PhP

Profit ( )%

PhP

Tax 5%

PhP \_\_\_\_\_

**TOTAL PROJECT COST**

PhP \_\_\_\_\_

PRINTED NAME/SIGNATURE OF AUTHORIZED REPRESENTATIVE

Designation: \_\_\_\_\_  
 Company Name: \_\_\_\_\_  
 Business Address: \_\_\_\_\_  
 PhilGEPS Registration No.: \_\_\_\_\_  
 Telephone Number: \_\_\_\_\_  
 Email Address: \_\_\_\_\_

## IMPROVEMENT OF AIRSTRIP AT PHILRICE CES

Contract Duration (120 CD)

The minimum work experience requirements for key personnel are the following:

<u>Key Personnel</u>	<u>General Experience</u>	<u>Relevant Experience</u>
Project Manager	Project Management	5 years
Project Engineer	General Construction	5 years
Materials Engineer	Materials Testing	5 years
In-house Health & Safety Officer	Occupational Health and Safety Standard	5 years
Foreman	General Construction	10 years

The minimum major equipment requirements are the following:

<u>Equipment</u>	<u>Capacity (min)</u>	<u>Number of Units</u>
Mini - Excavator/Backhoe	0.4 - 0.5 cu.m. bucket	1
Transit Mixer		3
One-Bagger Mixer		1
Concrete Vibrator		1
Cut-Off Machine		1
Bar Cutter		1
Vibratory Plate Compactor	1 ton	1
Welding Machine	300 amp	1
Acetylene/Oxygen Grinder		1(pair)
Electric Drill		2
Submersible Pump/Centrifugal Pump	10-12 lps	2
Air Compressor	1 hp	1
Mini Dump Truck/Elf	3 - 6 cu. m.	1





AIRSTRIP IMPROVEMENT

PROVISION OF RETAINING WALL w/ DESIGN/SIGNAGES and HOLLOW ART SIGNAGES

LEGEND:

- 1. BPT TYPE HOUSING AREA (OLD HOUSING) (0-1 & 6)
- 2. WHEAT AREA SCREEN HOUSE
- 3. WHEAT AREA HEAD-HOUSE
- 3a. WHEAT AREA PUMP HOUSE
- 4. SINGLE DETACHED HOUSING UNITS (S1 TO S7)
- 51 - SINGLE (RMarali) 55 - SINGLE (ON GOING RENOVATION)
- 52 - SINGLE (Vacant) 56 - SINGLE (Muyayon)
- 53 - SINGLE (MAluano) 57 - SINGLE (A/Espiritu)
- 54 - SINGLE (LMaroz) 58 - SINGLE (ON GOING RENOVATION)
- 5. DUPLEX HOUSING UNITS (D1 TO D-12)
- D-1 DUPLEX (RBay) D-7 DUPLEX (E-bay)
- D-2 DUPLEX (LBay) D-8 DUPLEX (K/BBarra)
- D-3 DUPLEX (LBay) D-9 DUPLEX (LUNon)
- D-4 DUPLEX (LBay) D-10 DUPLEX (H/Rong)
- D-5 DUPLEX (LBay) D-11 DUPLEX (LBay)
- D-6 DUPLEX (LBay) D-12 DUPLEX (T/CBarr)
- 6. STAFF DORMITORY
- 7. PLAYGROUND
- 8. STAFF VILLE COURT
- 9. DOMESTIC WATER TANK (1 APARTMENT-HOUSING/DORM)
- 10. 8 DOORS APARTMENT (FNLSA 1 TO 8)
- FNLSA 1 - Alcala FNLSA 5 - BarZagala
- FNLSA 2 - M/samro FNLSA 6 - AnlaRazon
- FNLSA 3 - EAracna FNLSA 7 - Malabayabas/Bra
- FNLSA 4 - J/Pascal FNLSA 8 - Tonyco/B'lorio
- 11. 8 DOORS APARTMENT (MILAGROSA 1 TO 8)
- MILAGROSA 1 - X/Cagulat MILAGROSA 5 - R/nz
- MILAGROSA 2 - F/Garcia MILAGROSA 6 - M/Skaby
- MILAGROSA 3 - Alunza MILAGROSA 7 - Vacant
- MILAGROSA 4 - G'n'ral/Nom'ga MILAGROSA 8 - Collado/Marucod
- 12. 6 DOORS APARTMENT (GALO 1 TO 6)
- GALO 1 - Vacant GALO 4 - Vacant
- GALO 2 - Vacant GALO 5 - Alunza
- GALO 3 - Vacant GALO 6 - Collado/Marucod
- 13. 3 DOORS APARTMENT (DINRADO 1 TO 3)
- DINRADO 1 - F/D'Alf'ra
- DINRADO 2 - Vacant
- DINRADO 3 - J/S-rapin
- 14. 6 DOORS APARTMENT (KALINAYAN 1 TO 6)
- KALINAYAN 1 - J/Kataw KALINAYAN 4 - J/H-Marab
- KALINAYAN 2 - L/D'Alf'ra KALINAYAN 5 - A/Cosio
- KALINAYAN 3 - A/Kagatano KALINAYAN 6 - K/Pasual
- 15. 6 DOORS APARTMENT (BALATINAW 1 TO 6)
- BALATINAW 1 - M/F'r'r BALATINAW 4 - Vacant
- BALATINAW 2 - M/F'r'r BALATINAW 5 - E/NavarCastillo
- BALATINAW 3 - R/Malasa BALATINAW 6 - R/Malalay
- 16. 4 DOORS APARTMENT (AZUCENA 1 TO 4)
- AZUCENA 1 - F/umaway AZUCENA 3 - O/Malanzo
- AZUCENA 2 - D/Es'mo AZUCENA 4 - J/B'dulalao
- 17. WAITING SHED 1 (NEAR MAIN GATE/STAFF HOUSE)
- 17a. WAITING SHED 2 (NEAR GATE OF STAFF DORM)
- 17b. WAITING SHED 3 (FRONT OF 2ND GATE)
- 17c. WAITING SHED 4 (BESIDES 2ND GATE)
- 18. SIGNBOARD TOWER (MAIN GATE)
- 19. ROCKEFELLER SCHOLARS HOUSING (R1 TO R5)
- Rock-F'r'r 1 - G/Jachtulr Rock-F'r'r 4 - R/R
- Rock-F'r'r 2 - M/Sagala Rock-F'r'r 5 - O/Lamas
- Rock-F'r'r 3 - E/Bardnil Rock-F'r'r 6 - M/Es'mo
- Rock-F'r'r 7 - A/M'nc'calvo
- 20. EXECUTIVE HOUSING (FCARRD) (EH 1 TO 4)
- FCARRD 1 - Vacant FCARRD 3 - S/Abula
- FCARRD 2 - S/Jullang FCARRD 4 - Vacant
- 21. RECREATIONAL PLAYING AREA (FOOD)
- 22. OLD GUESTHOUSE (MANGBAS)
- 23a. MANG TCO
- 23b. CR MANG TCO
- 24. LANDBANK (OLD)
- 25. GUARD-HOUSE (MAIN GATE)
- 26. TENNIS COURT
- 27. MINI CLUB HOUSE
- 28. BEACH VOLLEYBALL COURT
- 29. FOND (NEAR HYBRID BUILDING)
- 30. WEST TERMINAL (GENSET/POWERHOUSE)
- 31. SUBSTATION BY TRANSFER SWITCH BOARD TO HOUSING
- 32. DISTRIBUTION TRANSFORMER (WEST TERMINAL)
- 33. FLAG POLE
- 34. MAIN LAB BUILDING PARKING AREA
- 35. GUARD HOUSE (2ND GATE)
- 36. HELIPAD
- 37. OLD BUNKHOUSE (BACK EXEC. HOUSES)
- 38. FTIC FOND
- 39. SCREENHOUSE (FTIC BLDG.)
- 40. FTIC BUILDING
- 41. SOCIAL HALL
- 42. OLD CANTEEN/CAFETERIA FOND
- 43. OLD CANTEEN/CAFETERIA
- 44. IM50
- 45. RICE MUSEUM (OLD ADMIN)
- 46. PHILRICE MARKER
- 47. RICEWINE PRODUCTION BUILDING (Old Crop Production Bldg/BLOCK 9)
- 48. NEW RCPC BUILDING 1
- 49. RCPC (R/BU)
- 50. NEW RCPC BUILDING 2 (ON GOING CONST.)
- 51. OLD RCPC BUILDING
- 52. HYBRID WAREHOUSE (OLD PLANT BREEDING)
- 53. PLANT BREEDING WORKING AREA/SHED
- 54. PLANT BREEDING SERVICE BUILDING (HYBRID BLDG.)
- 55. PHILRICE TOWER
- 56. NEW ADMIN BUILDING (ON GOING CONST.)
- 57. GENETICS/GERMPLASM RESOURCES FACILITIES LAB (GRD)
- 58. MAIN BUILDING WATERPUMP
- 59. PHILRICE MAIN LABORATORY BUILDING (JICA)
- 60. COMMUNICATION TOWER
- 61. CAFETERIA
- 62. TRAINING DORM 1
- 63. TRAINING DORM 2
- 64. TRAINING DORM LAUNDRY AREA
- 65. POWERHOUSE (FOR CBC TERMINAL LINE)
- 66. NEW DA CROP BIOTECHNOLOGY CENTER LABORATORY AND PLINARY BUILDING (ON GOING CONST.)
- 66a. HELIPAD 3 (TO BE REMOVED FOR CBC SITE)
- 67. CHEMICAL AND HAZARDOUS STORAGE
- 68. SOUTH TERMINAL (GENSET AND POWERHOUSE)
- 69. RECORDS STORAGE/PRINTING BLDG. (FORMER CENTRAL SUPPLY BLDG.)
- 70. TREATMENT POND
- 71. GREENHOUSE WITH HEADHOUSE (JICA)
- 72. WORKING AREA AND STORAGE SHED WITH WASHING AREA (CPD/ASPPD)
- 73. EAST DOMESTIC WATER TANK (NEAR JICA GREENHOUSE)
- 74. SCREENHOUSE WITH HEADHOUSE (JICA)
- 75. REGULAR SCREENHOUSE - 2 FOR PBBD
- 76. REGULAR SCREENHOUSE - 2 FOR PBBD
- 77. COLD TOLERANCE SHED FACILITIES
- 78. CROP SERVICE BUILDING (TITANIC)
- 79. MID TERMINAL (PANEL BOARD)
- 80. PARKING AREA (ADJACENT TO BASKETBALL COURT)
- 81. BASKETBALL COURT
- 82. NORTH TERMINAL (GENSET/POWERHOUSE) (DISTRIBUTION TRANSFORMER)
- 83. NORTH TERMINAL POWERHOUSE STORAGE
- 84. KOICA POWERHOUSE/GENSET
- 85. KOICA SEED PROCESSING BUILDING
- 86. NEW BUFFER STOCK
- 87. SEED WAREHOUSE BUILDING (ON GOING CONST.)
- 88. REVERSIBLE FLATBED DRYER (2 UNITS)
- 89. BUFFER STOCK SEED WAREHOUSE (BOD)
- 90. BOD AND IAU OFFICE
- 91. SEED TECHNOLOGY BUILDING
- 92. NATIONAL SEED QUALITY CONTROL SERVICES (NSQCS)
- 93. FIELD SERVICE BUILDING (REMD WORKING AREA)
- 94. RICE MECHANIZATION AND ENVS CENTER (REMC)
- 95. REMD FOND
- 96. SCREENHOUSE AND HEADHOUSE
- a1. SCREENHOUSE 1 WITH HEADHOUSE (Facade)
- a2. SCREENHOUSE 2 WITH HEADHOUSE (Facade)
- b. SCREENHOUSE WITH HEADHOUSE (Braz'los)
- c. SCREENHOUSE WITH HEADHOUSE (Cagulat)
- d. SCREENHOUSE 1 (Existing Screenhouse)
- e. SCREENHOUSE 2 (Existing Screenhouse)
- f. TRANSGENIC SCREENHOUSE (Existing)
- g. HEADHOUSE (Existing Headhouse)
- h. HEADHOUSE 2 (Existing Headhouse)
- i. SCREENHOUSE 3 (Existing Screenhouse)
- j. SCREENHOUSE 4 (Existing Screenhouse)
- k. HEADHOUSE 3 (B'ra)
- l. RICE BLAST (Cagulat)
- 99. REMD MECHANICAL DRYER
- 97. REMD WORKING AREA
- 98. STAGE (TOLLGATE)
- 99. CROP PROCESSING SHED (TOLLGATE)
- 100. FOM WASHING AREA
- 101. PHYSICAL PLANT & FOM BUILDING
- 102a. FPMF BUILDING
- 102b. FPMF / CENTRAL WAREHOUSE
- 103. FOM MACHINERY POOL/WORKING AREA
- 104. MOTORPOOL SHED (Former FOM Str. #1011)
- 105. MOTORPOOL MAINTENANCE SHED (Former FOM Str. #1011)
- 105b. SERVICE BAY SHED AT THE MOTORPOOL
- 106. REMD WIND MILL
- 107. FOND (TRIANGLE)
- 108. AGRORIET
- 109. METHANE VAN PROJECT FIELD OFFICE
- 110. PUMPHOUSE (PALAYAMANAN AREA)
- 111. PALAYAMANAN WORKING SHED 1
- 112. SOUTH DOMESTIC WATER TANK (R/BAS/PALAYAMANAN)
- 113. PALAYAMANAN WORKING SHED 2
- 114. PALAYAMANAN RBAS OFFICE
- 115. RBAS FACILITIES (A/B/C/D/E/F)
- 116. PALAYAMANAN WORKING SHED 3
- 117. OUTPOST GUARDHOUSE (AIRSTRIP)
- 118. MATERIAL RECOVERY FACILITY AREA
- 119. FUTURE RICE AREA
- 119a. FUTURE RICE (1"vat'd water tank with pump)
- 120. a/b/c GATE, DRIVEWAY ALONG MABIN ROAD

PHILRICE CENTRAL EXPERIMENT STATION  
SITE DEVELOPMENT PLAN

SITE DEVELOPMENT PLAN



P.A. 9286 - ART. 3, SECTION 20  
Drawings and Specifications duly signed, stamped or sealed, as returns of service are the intellectual properties and documents of the architect, whether the object for which they are made is executed or not. It shall be unlawful for any person without the consent of the architect or author of said documents, to duplicate or to make copies of said documents for use in the repetition of and for other projects or buildings, whether executed partly or in whole.

PROJECT TITLE:

IMPROVEMENT OF AIRSTRIP FOR PHILRICE CES  
PHILRICE - CES, MALIGAYA, CITY OF MUNOZ NUEVA ECUIJA

PRODUCED BY:

PHYSICAL PLANT DIVISION  
INFRASTRUCTURE UNIT  
PHILRICE  
SCIENCE CITY OF MUNOZ, NUEVA ECUIJA

DESIGN BY:

Arch. RENATO B. BAUT  
PPD DIVISION HEAD  
PHILRICE-CES

RECOMMENDING APPROVAL:

GEN. T. MONTECALVO  
DEP FOR ASB  
PHILRICE-CES

APPROVED:

Dr. JOSE C. DE LEON  
EXECUTIVE DIRECTOR  
PHILRICE-CES

DESIGN BY: RB8

DATE: MAR. 2020  
CADD BY: RB8M  
DATE: MAR. 2020  
CHECKED BY: RB8

SHEET NUMBER:

A1  
1 8



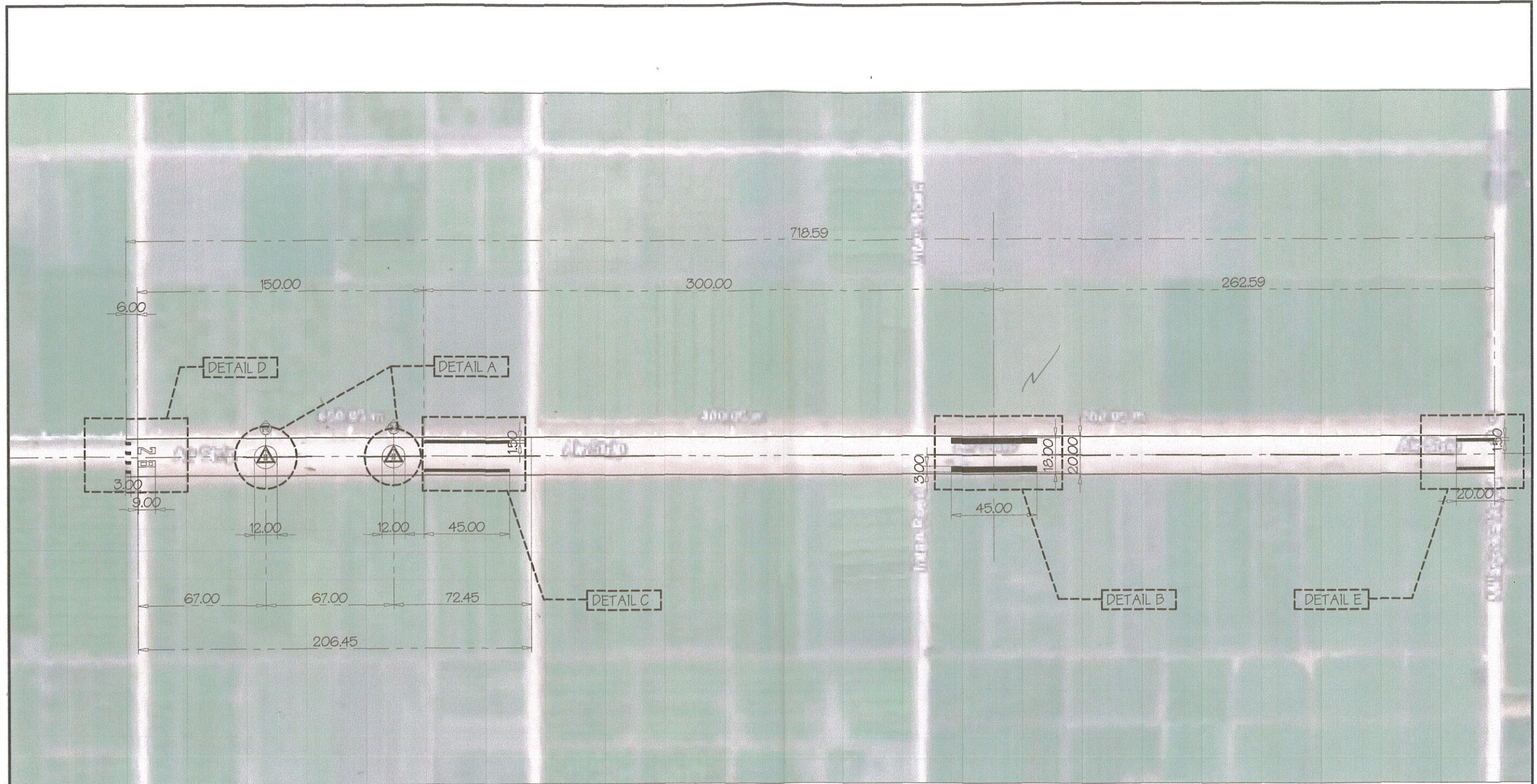



**SITE DEVELOPMENT PLAN (AIRSTRIP ROAD)**  
 SCALE 1:1000 METERS

 <b>PHILIPPINE RICE RESEARCH INSTITUTE</b> CENTRAL EXPERIMENT STATION MALIGAYA, MUNOZ CITY, NUEVA ECUA	R.A. 9266 - ART. 3, SECTION 20 <small>Drawings and Specifications duly signed, stamped or sealed, as instruments of service are the intellectual properties and documents of the architect, whether the object for which they are made is executed or not. It shall be unlawful for any person, without the consent of the architect or author of said documents to duplicate or to make copies of said documents for use in the repetition of and for other projects or buildings, whether executed partly or in whole.</small>	PROJECT TITLE <b>IMPROVEMENT OF AIRSTRIP FOR PHILRICE CES</b> PHILRICE - CES, MALIGAYA, CITY OF MUNOZ NUEVA ECUA	PRODUCED BY: PHYSICAL PLANNING DIVISION INFRASTRUCTURE UNIT PHILRICE SCIENCE CITY OF MUNOZ, NUEVA ECUA	DESIGN BY: Archt. REMATO B. BAJIT PPD DIVISION HEAD PHILRICE-CES	RECOMMENDING APPROVAL  ARMAR T. MONTECALVO DEP FOR ASF PHILRICE-CES	APPROVED  DR. JOHN C. DE LEON EXECUTIVE DIRECTOR PHILRICE-CES	DESIGN BY: RBB DATE: AUG 2020 CADD BY: RABM DATE: AUG 2020 CHECKED BY: RBB	SHEET NUMBER A2 2 8
--	---	--	--	---	--	--	--	---------------------------

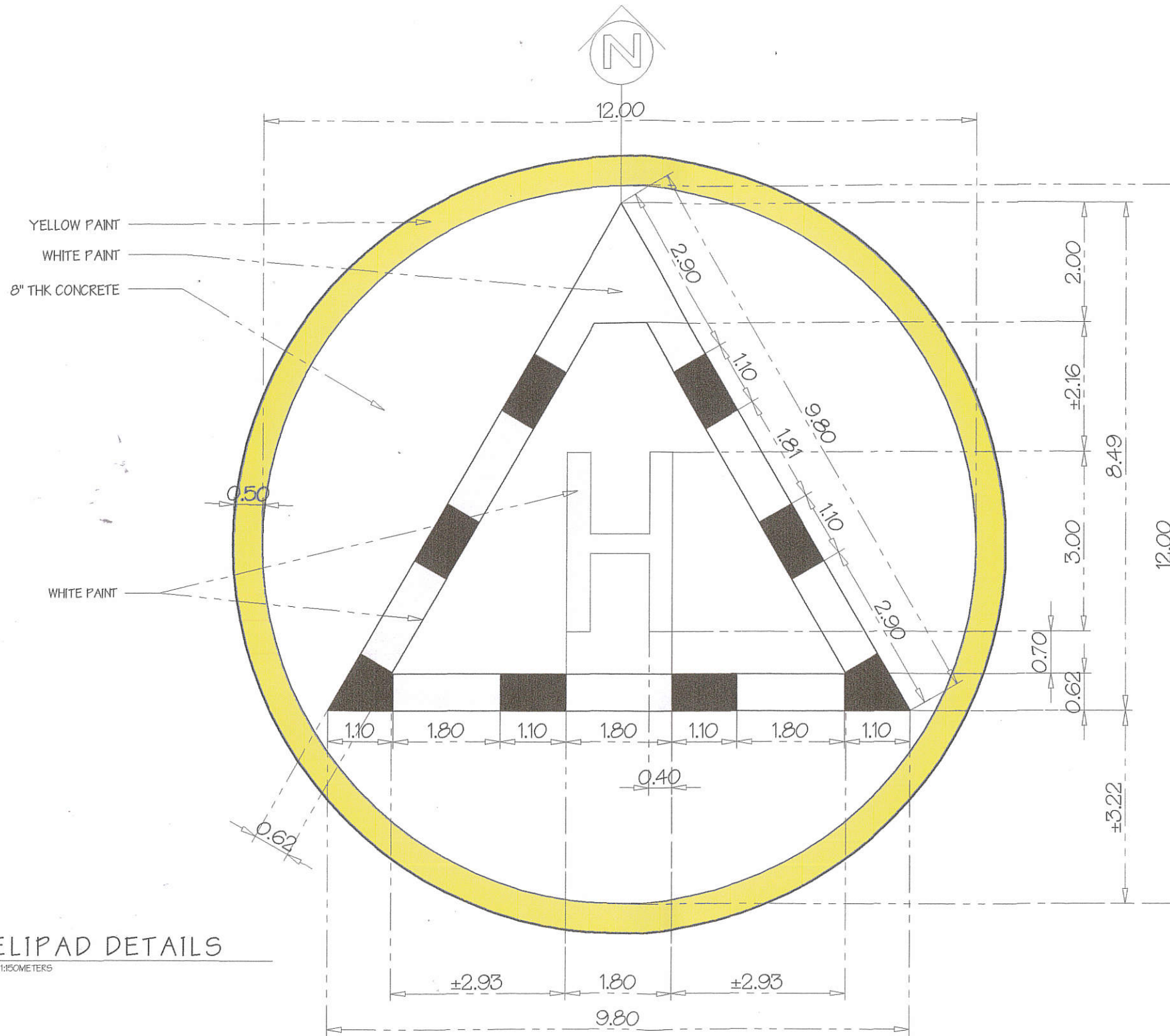



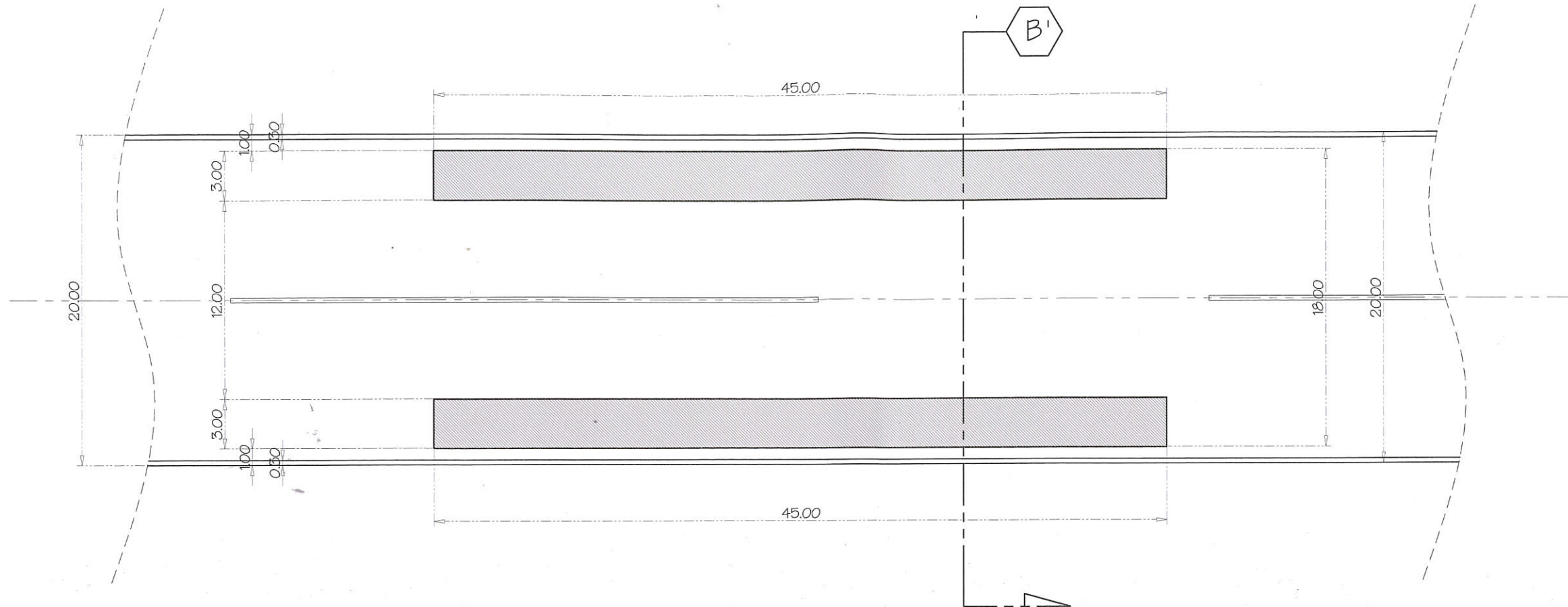

**HELIPAD DETAILS**  
 SCALE 1:150 METERS

 <b>PHILIPPINE RICE RESEARCH INSTITUTE</b> <small>CENTRAL EXPERIMENT STATION MALIGAYA, MUNOZ CITY, NUEVA ECUA</small>	<small>RA 9266 - ART. 3, SECTION 20</small> <small>Drawings and Specifications duly signed, stamped or sealed, as instruments of service are the intellectual properties and documents of the architect, whether the object for which they are made is executed or not. It shall be unlawful for any person, without the consent of the architect or author of said documents to duplicate or to make copies of said documents for use in the repetition of and for other projects or buildings, whether executed partly or in whole.</small>	<small>PROJECT TITLE</small> <b>IMPROVEMENT OF AIRSTRIP FOR PHILRICE CES</b> <small>PHILRICE - CES, MALIGAYA, CITY OF MUNOZ NUEVA ECUA</small>	<small>PRODUCED BY:</small> <small>PHYSICAL PLANT DIVISION INFRASTRUCTURE UNIT PHILRICE SCIENCE CITY OF MUNOZ, NUEVA ECUA</small>	<small>DESIGN BY:</small>  <small>Arch. RENATO B. BAJIT PPD DIVISION HEAD PHILRICE CES</small>	<small>RECOMMENDING APPROVAL</small>  <small>ABNER T. DOMECALVO DED FOR A SP PHILRICE CES</small>	<small>APPROVED</small>  <small>Dr. JOSE DE LEON EXECUTIVE DIRECTOR PHILRICE CES</small>	<small>DESIGN BY: RBB</small> <small>DATE: AUG 2020</small> <small>CADD BY: RABM</small> <small>DATE: AUG 2020</small> <small>CHECKED BY: RBB</small>	<small>SHEET NUMBER</small> <b>A3</b> <b>3</b> / <b>8</b>
--	--	--	--	---	--	---	---	---

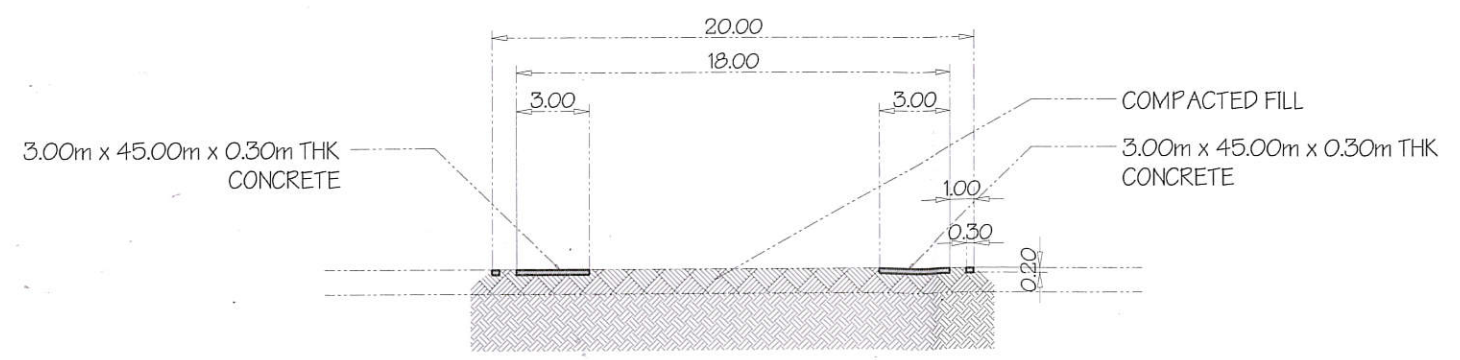

**DETAIL B**  
SCALE 1:300 METERS



**SECTION THRU B'**  
SCALE 1:150 METERS



F.A. 9266 - ART. 3, SECTION 20  
Drawings and Specifications duly signed, stamped or sealed as instruments of service are the intellectual properties and documents of the architect, whether the object for which they are made is executed or not. It shall be unlawful for any person, without the consent of the architect or author of said documents, to duplicate or to make copies of said documents for use in the repetition of and for other projects or buildings, whether executed partly or in whole.

PROJECT TITLE:  
**IMPROVEMENT OF AIRSTRIP FOR PHILRICE CES**  
PHILRICE - CES, MALIGAYA, CITY OF MUNOZ NUEVA ECUIA

PRODUCED BY:  
PHYSICAL PLANT DIVISION  
INFRASTRUCTURE UNIT  
PHILRICE  
SCIENCE CITY OF MUNOZ, NUEVA ECUIA

DESIGN BY:  
Arch. RENATO B. BALIT  
PPD DIVISION HEAD  
PHILRICE CES

RECOMMENDING APPROVAL:  
ARNER T. MORALES  
DED FOR ASP  
PHILRICE CES

APPROVED:  
Dr. JOHN C. DE LEON  
EXECUTIVE DIRECTOR  
PHILRICE CES

DESIGN BY: RBB  
DATE: AUG. 2020  
CADD BY: RABM  
DATE: AUG. 2020  
CHECKED BY: RBB

SHEET NUMBER:  
A4  
4 8



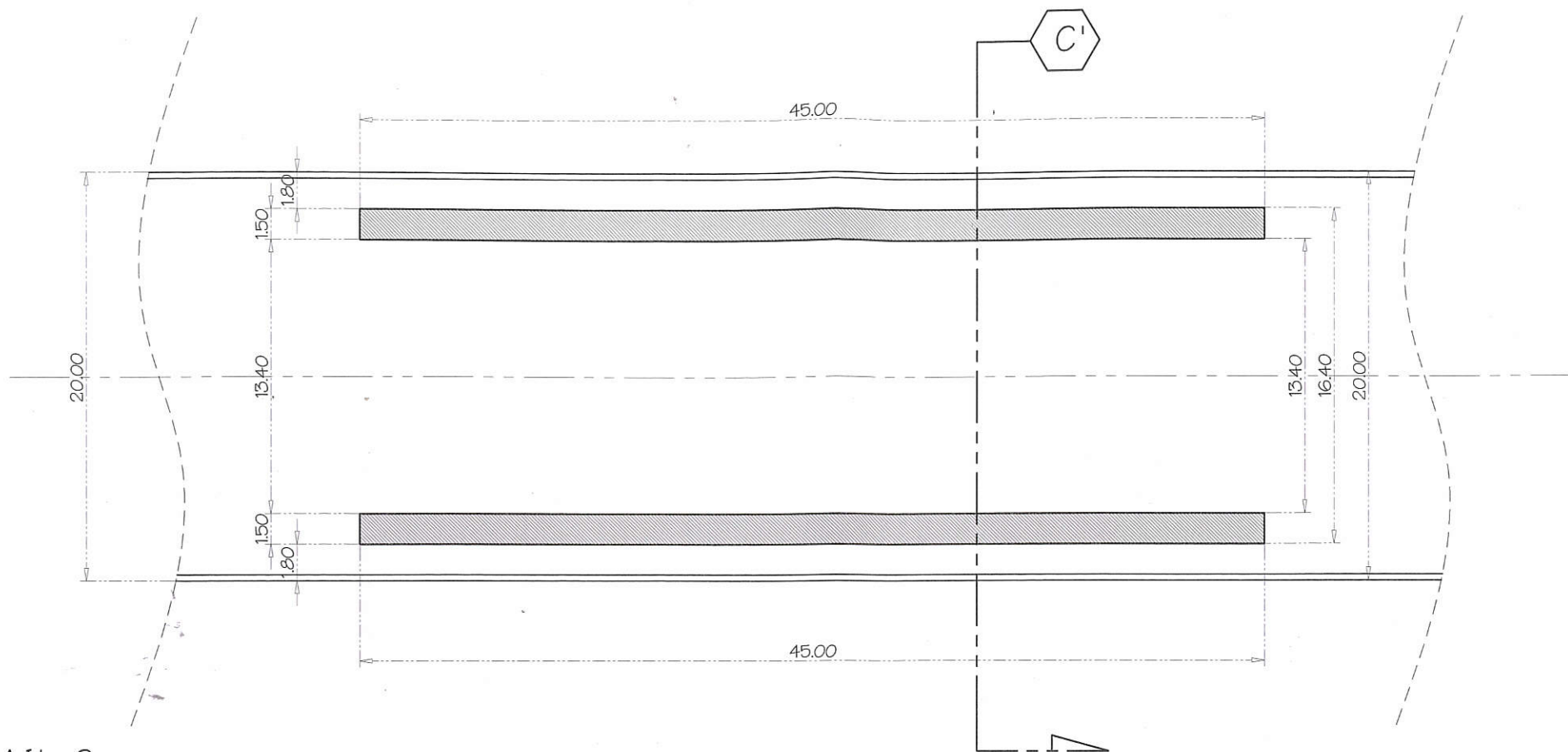

**DETAIL C**  
SCALE 1:300 METERS

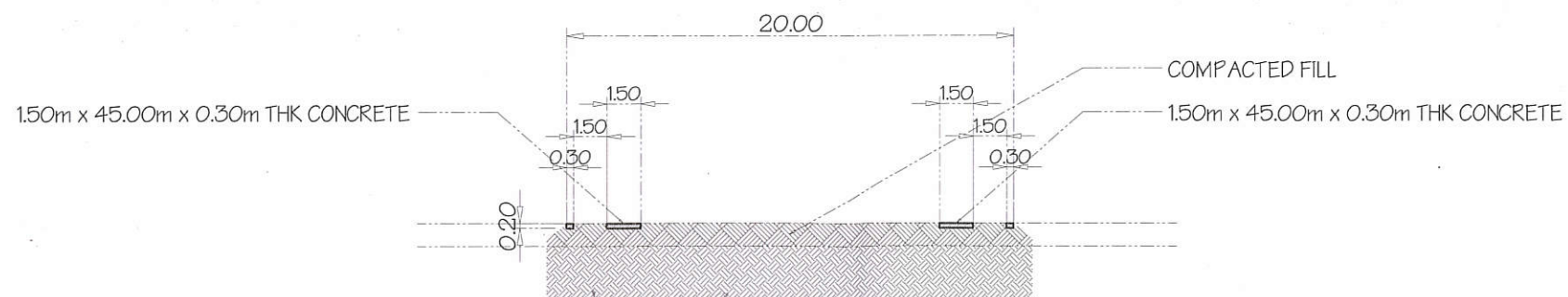

**SECTION THRU C'**  
SCALE 1:150 METERS



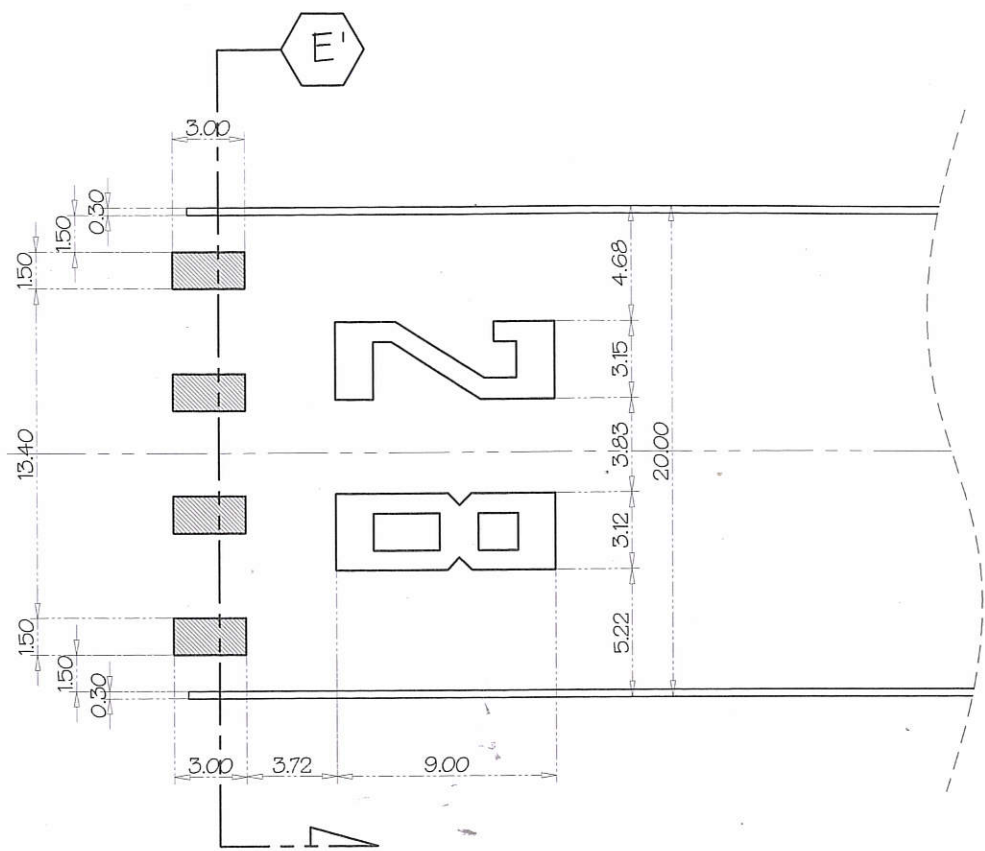

**DETAIL D**  
SCALE 1:300 METERS

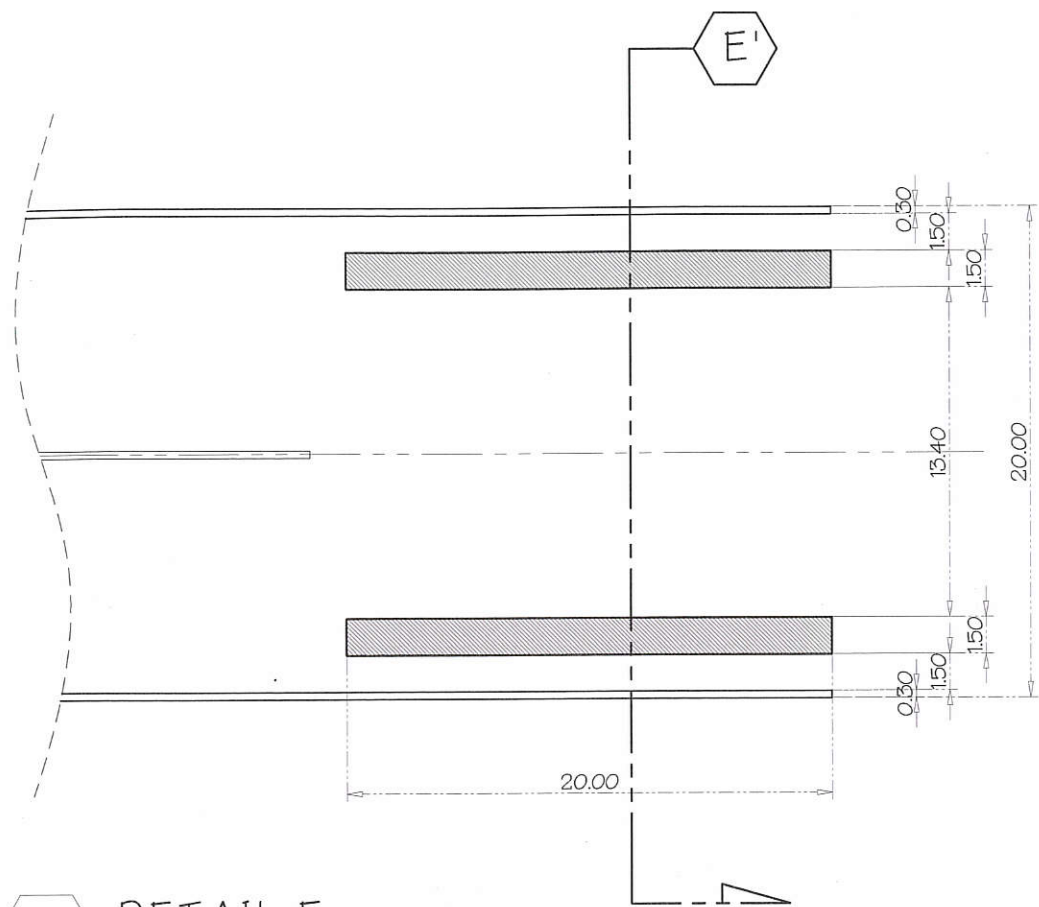

**DETAIL E**  
SCALE 1:300 METERS

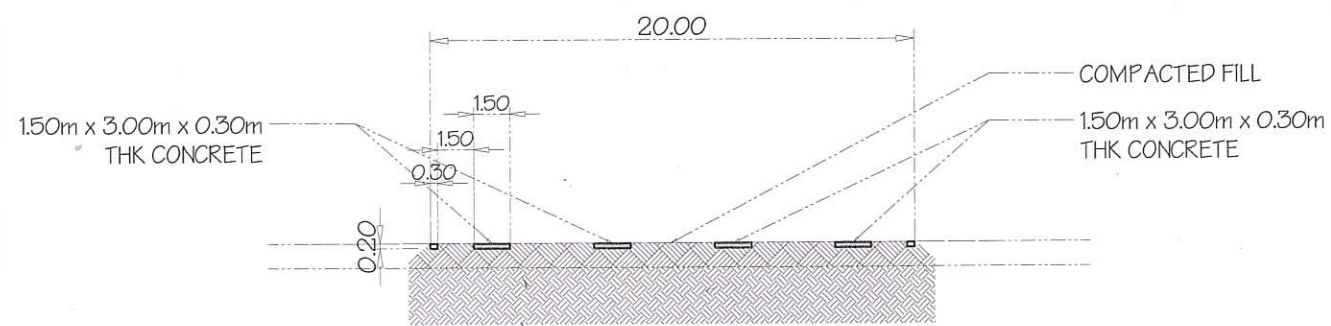

**SECTION THRU D'**  
SCALE 1:150 METERS

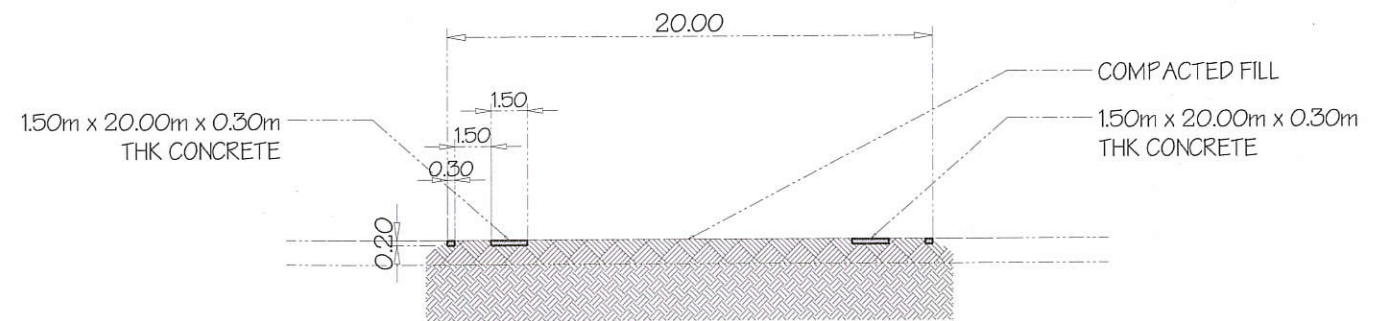

**SECTION THRU E'**  
SCALE 1:150 METERS



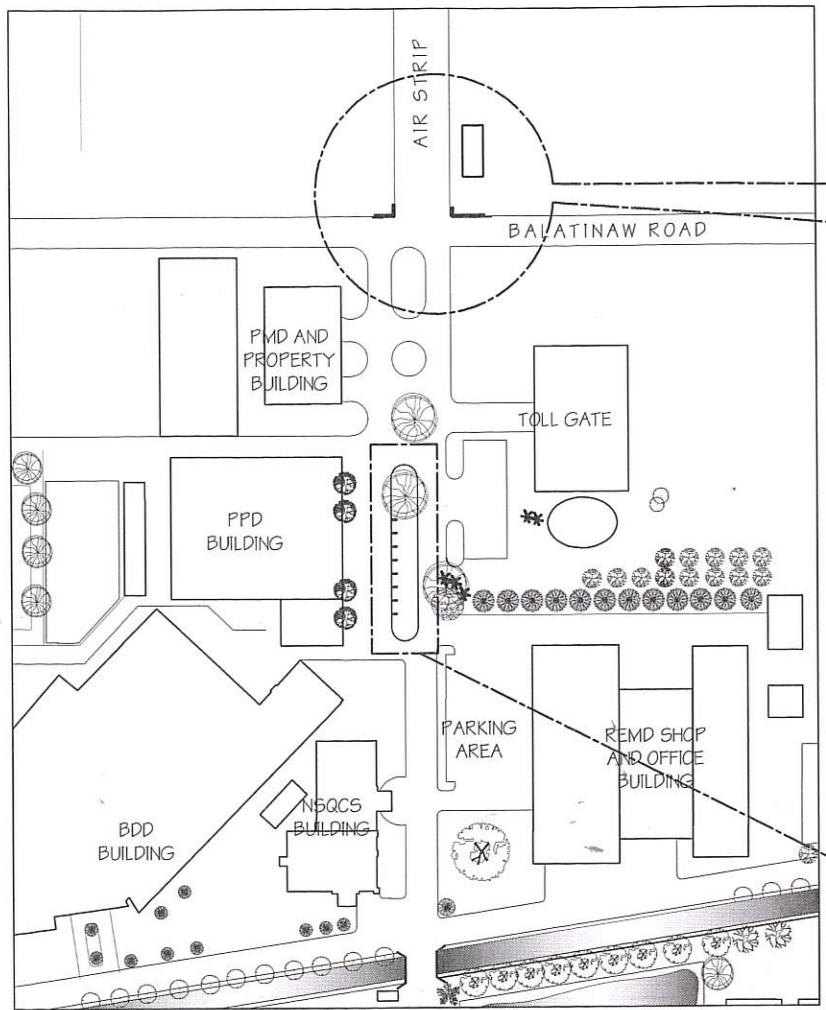

LOCATION PLAN  
SCALE 1: NTS

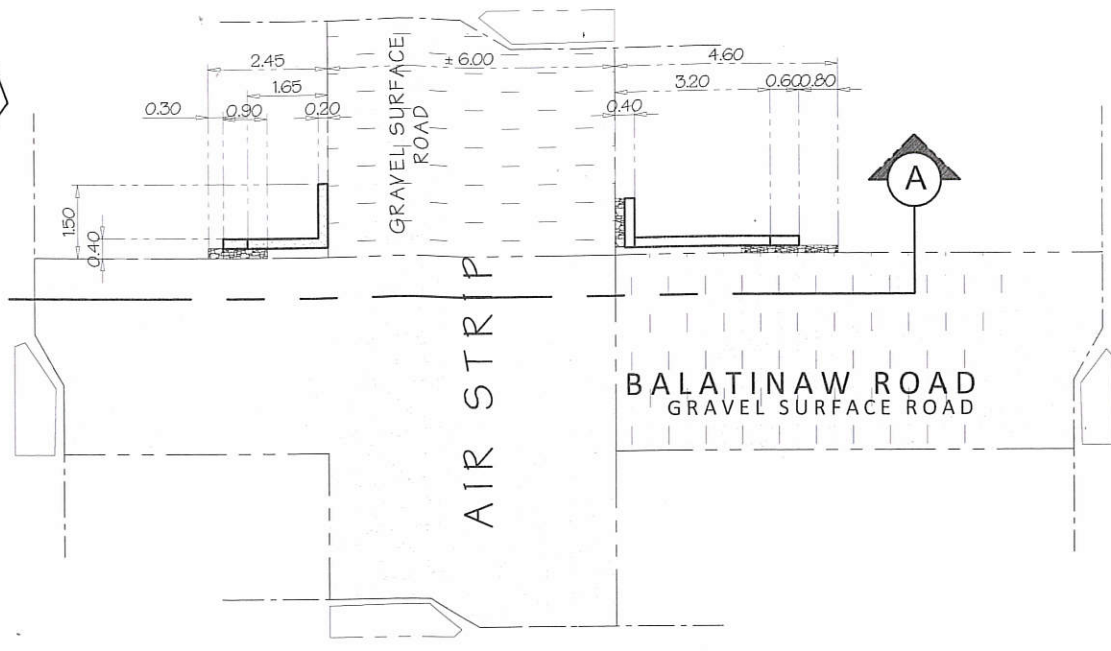

FLOOR PLAN  
SCALE 1: 150 MTS

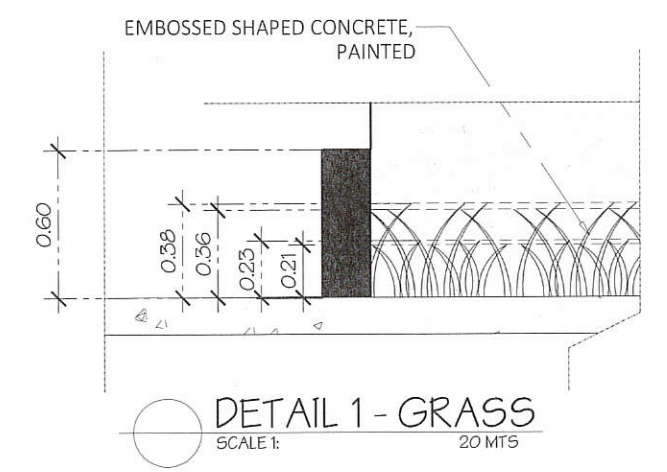

DETAIL 1 - GRASS  
SCALE 1: 20 MTS

SEVEN SETS OF HOLLOW ART ON CONCRETE (SEE DETAILS) PLACED ON THIS GRASS ISLAND (IN FRONT OF PPD BUILDING)

CHB WALL, PLASTERED PAINT FINISH  
Prime surface with BOYSEN® Acrytex™ Primer #1705.  
Fill hairline cracks and minor surface imperfections with BOYSEN® Acrytex™ Cast #1711 using a putty knife.  
Spot prime puttied portions with BOYSEN® Acrytex™ Primer #1705. Apply 3 coats of BOYSEN® Acrytex™ Topcoat of desired sheen by brush or roller (PAINT BRAND SHALL BE OF APPROVED EQUAL)

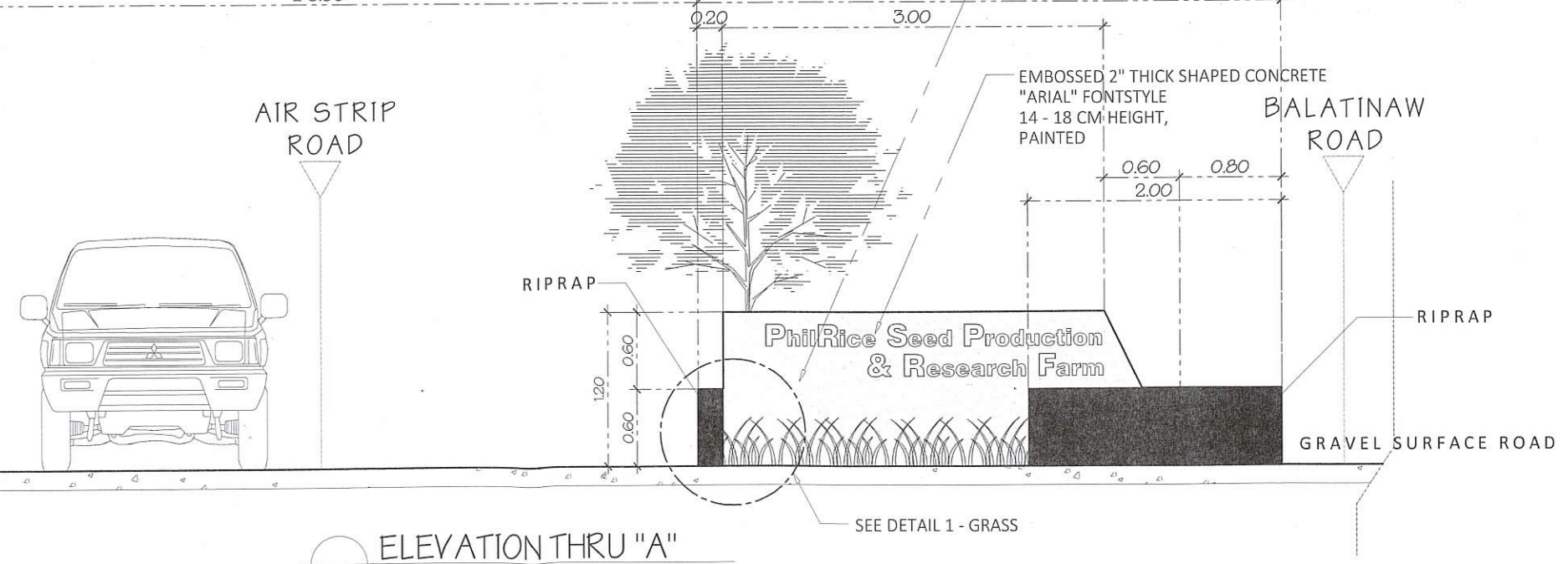
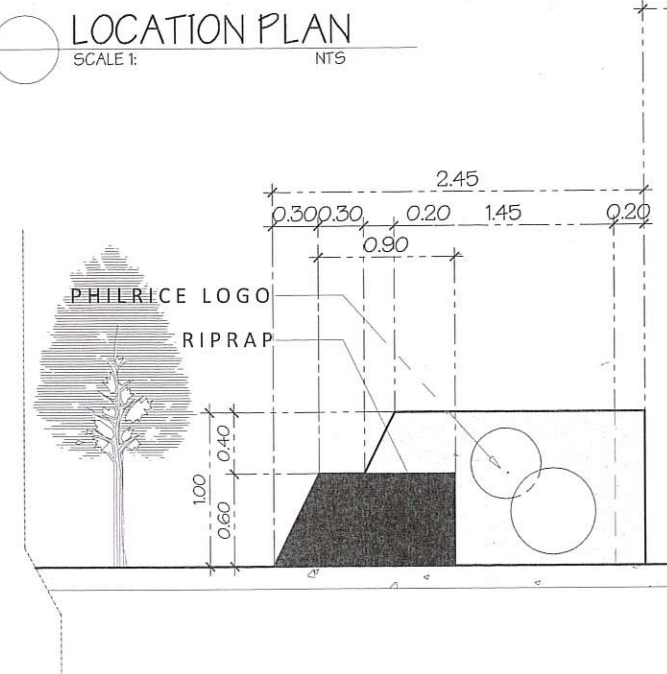

ELEVATION THRU "A"  
SCALE 1: NTS



P.A. 9266 - ART. 3, SECTION 20  
Drawings and Specifications duly signed, stamped or sealed as instruments of service are the intellectual properties and documents of the architect, whether the object for which they are made is executed or not. It shall be unlawful for any person without the consent of the architect or author of said documents, to duplicate or to make copies of said documents for use in the repetition of and for other projects or buildings, whether executed partly or in whole.

PROJECT TITLE:  
**IMPROVEMENT OF AIRSTRIP FOR PHILRICE CES**  
PHILRICE - CES, MALIGAYA, CITY OF MUNDOZ NUEVA ECJUA

PRODUCED BY: PHYSICAL PLANT DIVISION INFRASTRUCTURE UNIT PHILRICE SCIENCE CITY OF MUNDOZ, NUEVA ECJUA	DESIGN BY: Arch. RENATO B. BAJIT PPD DIVISION HEAD PHILRICE-CES	RECOMMENDING APPROVAL: ABNER T. MONTECALVO DED FOR ASST PHILRICE-CES	APPROVED: Dr. JOHNC. DE LEON EXECUTIVE DIRECTOR PHILRICE-CES	DESIGN BY: RBB DATE: AUG. 2020 CADD BY: MG DATE: AUG. 2020 CHECKED BY: RBB	SHEET NUMBER: A7 7 8
---	--	---	---	--	----------------------------



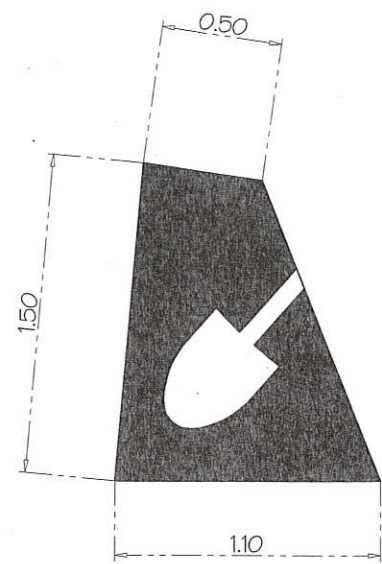

1

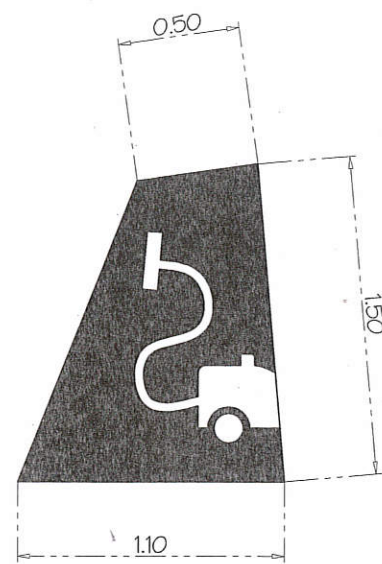

2

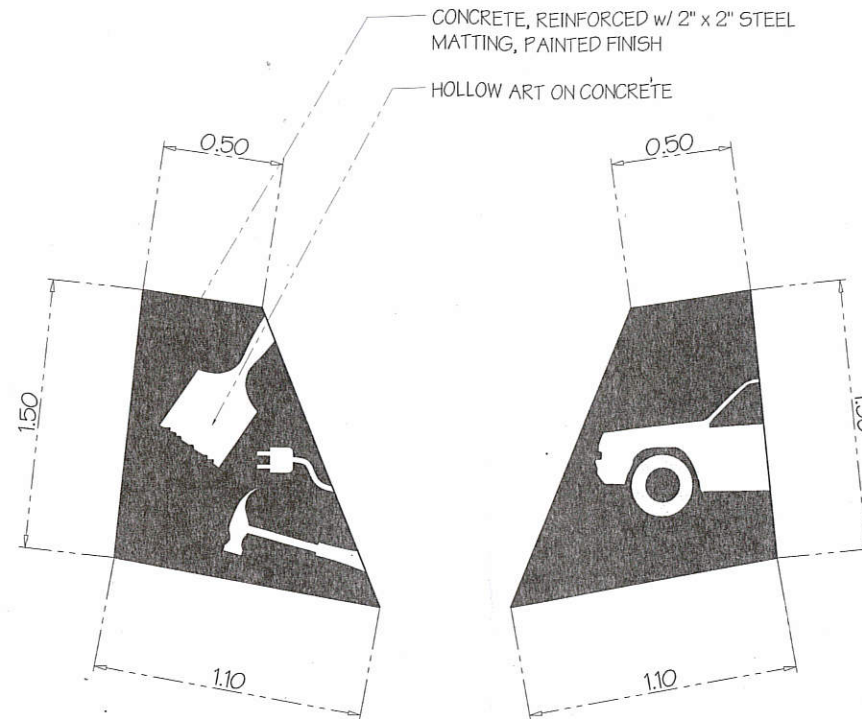

3

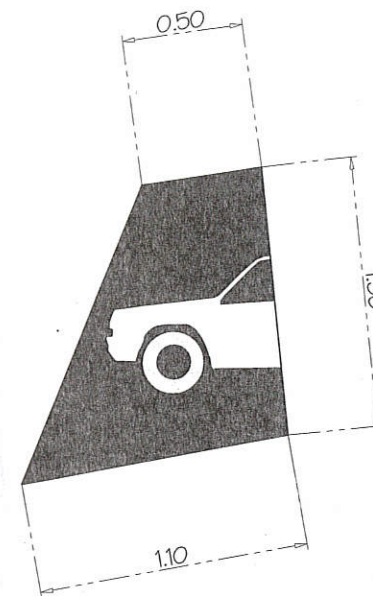

4

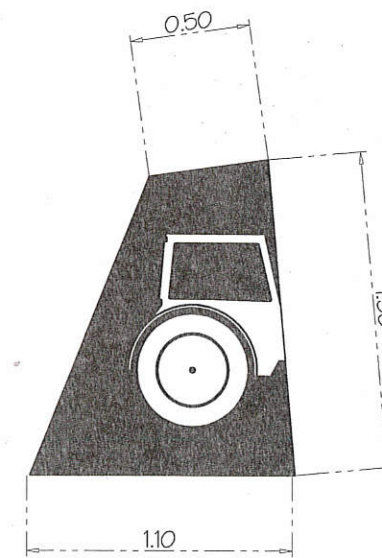

5

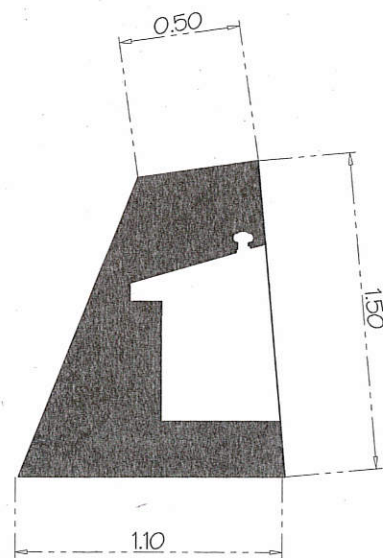

6

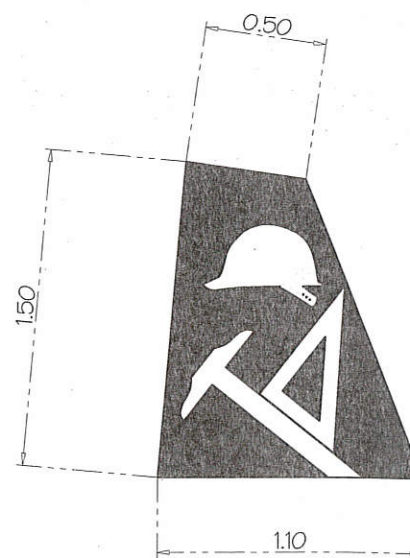

7

ELEVATION "HOLLOW ART"  
SCALE 1: NTS

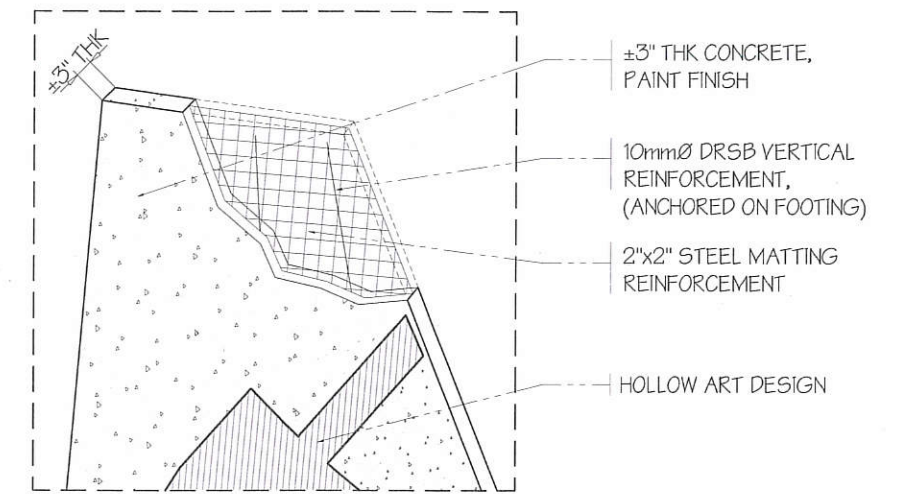

REINFORCEMENT DETAILS

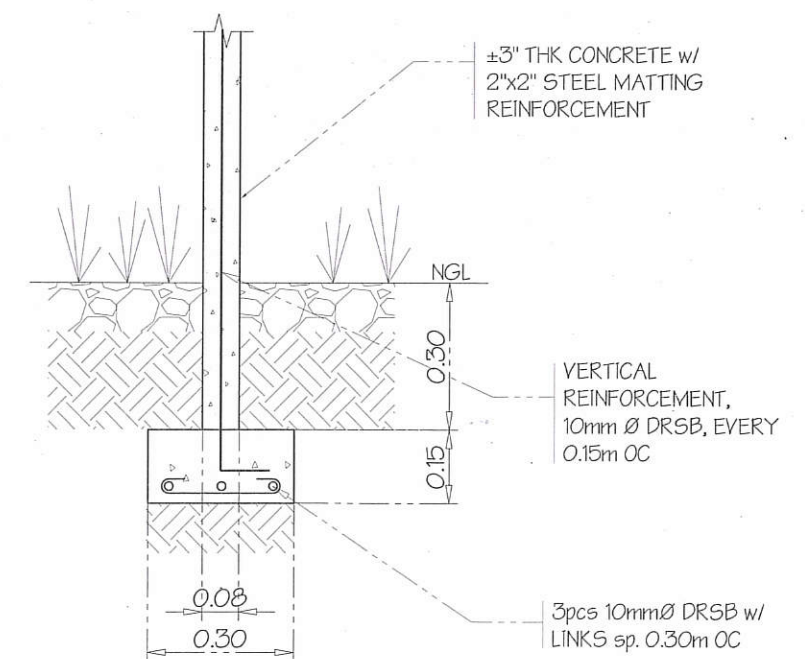

FOUNDATION DETAILS