

August 3, 2020

Bid Bulletin No. 1

Subject: Supply, Delivery and Installation of Laboratory Tables under PB 20-03-19

This bid bulletin is being issued to reflect the changes in the Schedule of Requirements and Technical Specifications for PB 20-03-19 Supply, Delivery and Installation of Laboratory Tables as follows:

REVISED TECHNICAL SPECIFICATIONS AND ATTACHED FLOOR PLANS/LAYOUT:

Attached is the Revised Technical Specifications and Floor Plans/Layout for complete details.

Please be guided accordingly.

GENARO S. RILLON
Chairperson, BAC for Goods and Services



Section VI. Schedule of Requirements

The delivery schedule expressed as weeks/months stipulates hereafter a delivery date which is the date of delivery to the project site.

Item no.	Description	Qty	Unit	Total ABC	Division	Delivery Period
1.	Supply, Delivery and Installation of Laboratory Tables 1 lot Laboratory Table (L-shape) 1 unit Laboratory Table (U-shape)	1	Lot	500,000.00	STU-GRD	Within 60 to 90 days upon receipt of PO/NTP
2.	Supply, Delivery and Installation of Laboratory Tables 2 units Center Laboratory Tables	1	Lot	500,000.00	ASPPD	Within 60 to 90 days upon receipt of PO/NTP

Technical Specifications

Item	Specification	Statement of Compliance
1.	<p>Supply, Delivery and Installation of Laboratory Tables for STU-GRD</p> <p>1 Lot Laboratory Side Table (L-shape) Dimensions: Room Size: 7.32m x 5.64m Total Area Size: 41.28m</p> <p>Specifications:</p> <p>Unit Laboratory Side Table (L-shape) Side Table Dimensions: Height: 787.4 mm Width: 650 mm Length: 7300 mm (Side A) w/ (6-7 cabinets) Length: 3190 mm (Side B) w/ (3 cabinets)</p>	<p>Bidders must state here either "Comply" or "Not Comply" against each of the individual parameters of each Specification stating the corresponding performance parameter of the equipment offered. Statements of "Comply" or "Not Comply" must be supported by evidence in a Bidders Bid and cross-referenced to that evidence. Evidence shall be in the form of manufacturer's un-amended sales literature, unconditional statements of specification and compliance issued by the manufacturer, samples, independent test data etc., as appropriate. A statement that is not supported by evidence or is subsequently found to be contradicted by the evidence presented will render the Bid under evaluation liable for rejection. A statement either in the Bidders statement of compliance or the supporting evidence that is found to be false either during Bid evaluation, post-qualification or the execution of the Contract may be regarded as fraudulent and render the Bidder or supplier liable for prosecution subject to the provisions of ITB Clause 3.1(a)(ii) and/or GCC Clause 2.1(a)(ii).</p>

Length: 1200 mm (Side C) w/ (1 cabinet)
Length: 5800 mm (Side D) w/ (4-6 cabinets)
Built in Cabinet Dimensions:
Height: 736.6 mm
Length: 532.6 mm
Distance between cabinets: 609.6 mm (2 ft)

Table Top: Epoxy resin at least 1" thickness of resin with superior chemical resistance and physical properties with static vibration damping technology to provide ideal surface for calibrated equipment (acid resistant), molded resin edge less and semi-gloss finish
Base: Epoxy coated steel tubular legs, base and frames with adjustable leveler.
Features: Electrical outlets 2gang, 220 VAC, splash board mounted Aprons with soft sliding drawer with lock
Built in – base cabinets with lock concealed hinge swing doors
Built in – Base cabinets with lock each with sliding drawers

1 unit Laboratory Side Table (U-shape)

Dimensions:
Width: 650mm
Length: 5040 mm (Side A)
Length: 4000mm (Side B)
Length: 2640mm (Side C)
Height: 850mm
Table Top: Epoxy resin with superior chemical resistance and physical properties with static vibration damping technology to provide ideal surface for calibrated equipment (acid resistant), molded resin edge less and semi-gloss finish
Base: Epoxy coated steel tubular legs, base and frames with adjustable leveler.
Features: Electrical outlets 2gang, 220 VAC, splash board mounted Aprons with soft sliding drawer with lock
Built in – base cabinets with lock concealed hinge swing doors

	<p>Built in – Base cabinets with lock each with sliding drawers</p> <p>SEE ATTACHED LAYOUT</p>	
<p>2.</p>	<p>Supply, Delivery and Installation of Laboratory Tables for ASPPD</p> <p>2 units Center Laboratory Tables Table top: acid resistant With overlaying chemical cabinets With power posts At least 3 cabinets on each side, and additional 2 drawers below the table top, in between the cabinets also on each side of the table. Total of 6 cabinets and 4 drawers per center laboratory tables. Dimensions: 1.5m x 4.5m x 0.90m</p> <p>SEE ATTACHED LAYOUT</p>	

Floor Plan –U Shape Laboratory Table

LAYOUT:

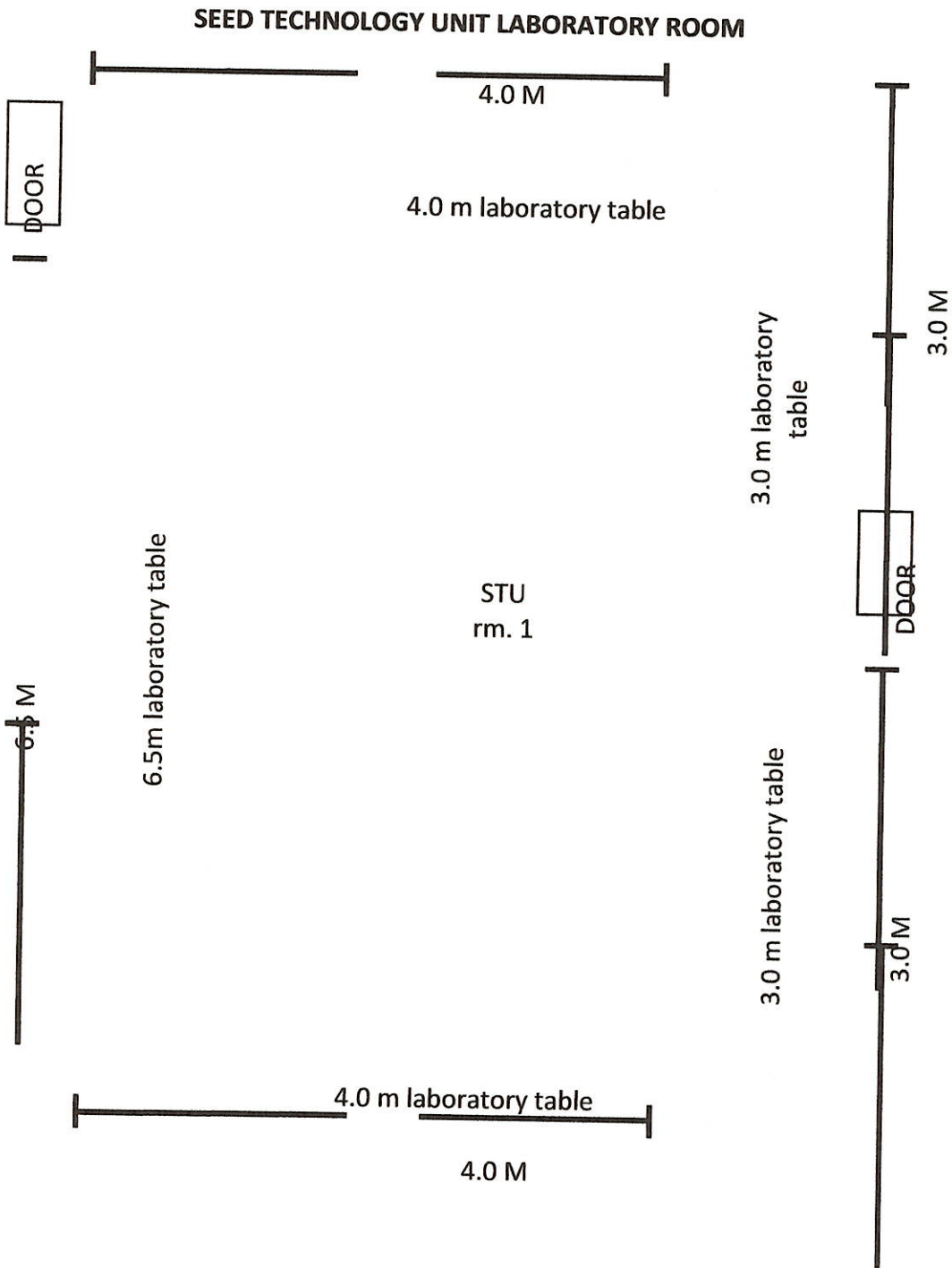

PROPOSED DESIGN:



ROOM LAYOUT:

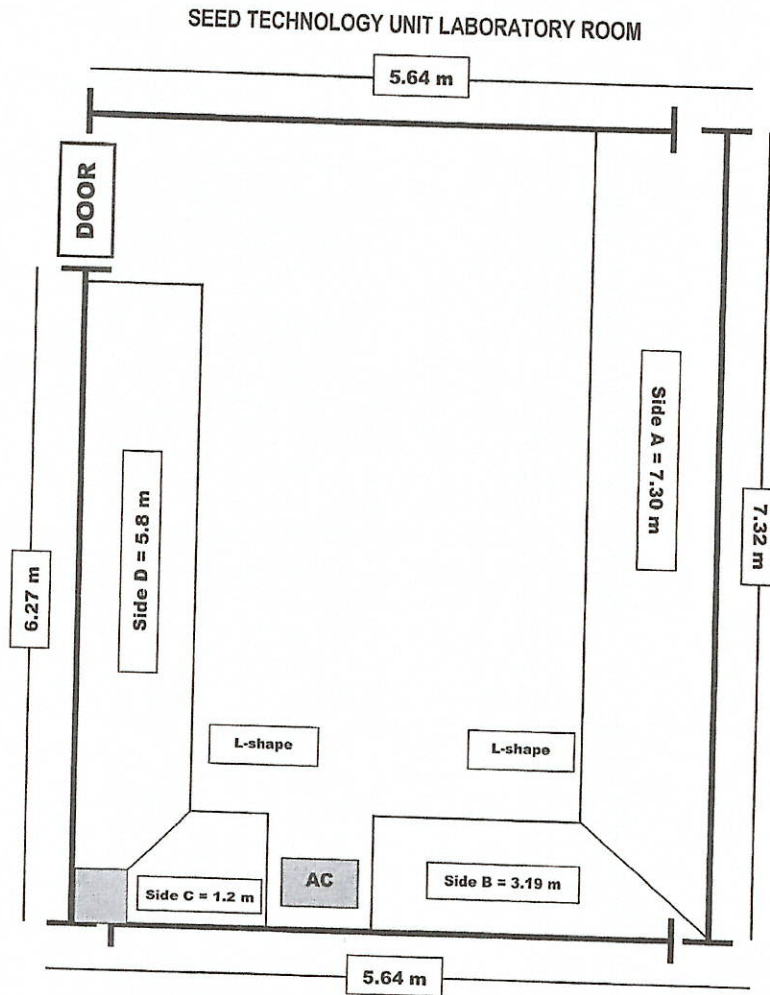

SEED TECHNOLOGY UNIT – LABORATORY
SIDE TABLES

ROOM SIZE: 7.32m x 5.64m
TOTAL AREA SIZE: 41.28 m

Specifications:

Unit: Laboratory Side Table (L-shape)

Side Table Dimensions:

- Height: 787.4 mm
- Width: 650 mm
- Length: 7300 mm (Side A) w/ (6-7 cabinets)
- Length: 3190 mm (Side B) w/ (3 cabinets)
- Length: 1200 mm (Side C) w/ (1 cabinet)
- Length: 5800 mm (Side D) w/ (4-6 cabinets)

Built in Cabinet Dimensions:

- Height: 736.6 mm
- Length: 532.6 mm
- Distance between cabinets: 609.6 mm (2ft)

Table Top: Epoxy resin with superior chemical resistance and physical properties with static vibration damping technology to provide ideal surface for calibrated equipment

Base: Epoxy coated steel tubular legs, base and frames with adjustable leveler.

Features: Electrical outlets 2gang, 220 VAC, splash board mounted

- Aprons with soft sliding drawer with lock
- Built in – base cabinets with or w/o lock concealed hinge 2 swing doors
- Built in – cabinets w/ or w/o lock each with 4 drawers

PROPOSED DESIGN:

TABLE WITH BUILT IN CABINETS



TABLE CORNER



BUILT IN CABINETS WITH 2ft DISTANCE BETWEEN



For Item number 2

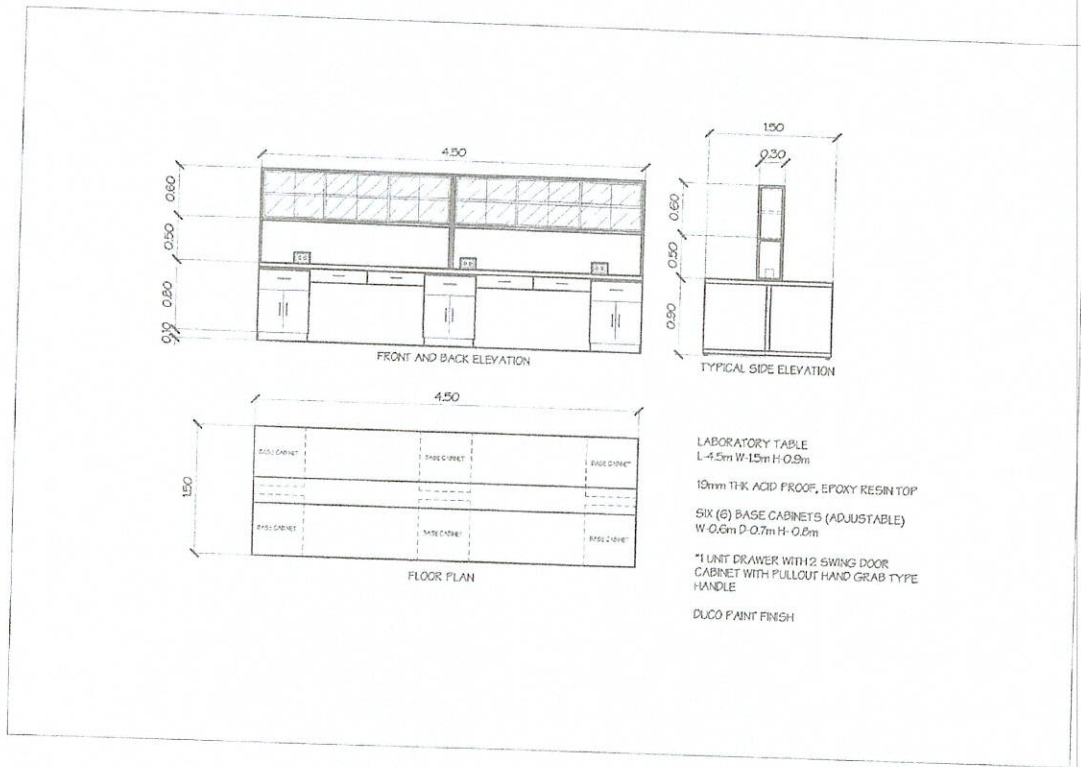

[Handwritten signature]